

## A3504MG100E

### Product Features

Gigabit Ethernet interface, providing 1Gbps bandwidth with a maximum transmission distance of 100m;  
 128MB on-board cache for data transmission or image resend;  
 Support Software Trigger/Hardware Trigger/Free Run Mode;  
 Support ISP functions including Sharpness/Denoising/Gamma/LUT/BlackLevel Correction/TargetBrightness/Contrast etc.;  
 Support multiple image data formats output/ROI/Binning/Mirror, etc.;  
 Conform to GigE Vision V2.0 protocol and GenICam standard;  
 DC 9V~24V wide voltage power supply; Conform



### Dimensions ( mm )

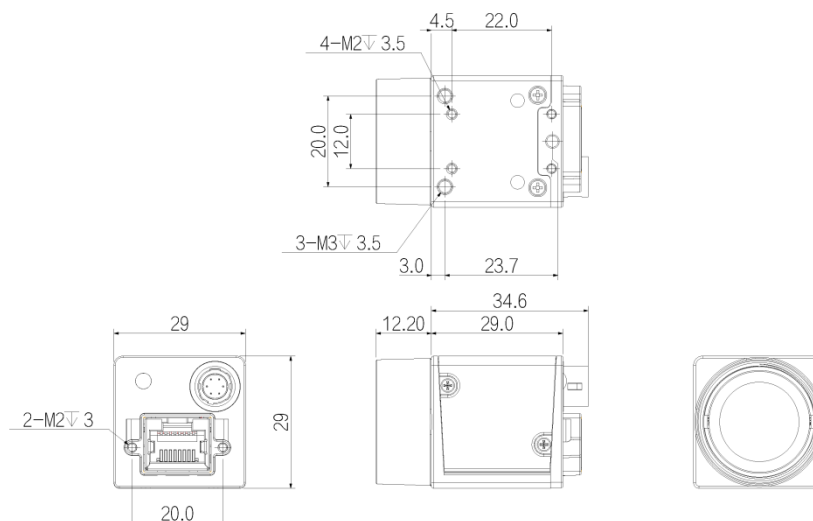

## Technical Specifications

Model Name	A3504MG100E
ROI	Support
Resolution	2592 x 1944
SPC	Support
Sensor	AR0521
Shutter	Rolling
Trigger Mode	Software Trigger/Hardware Trigger/Free Run Mode
User Setting	Support two sets of user-defined configurations
WDR	74.3dB
Weight	60g
Working Environment	Storage: - 30°C~ 80°C ; Operation: - 30°C~ 50°C
Exposure Time	21.5μS~1S
Binning	Support
Bit Depth	12
Frame Rate	23
GPIO Interface	1x 6 pin Hirose: 1x Opto-isolated input, 1x Opto-isolated output, 1 configurable input and output
Gain	1~32
Gamma	From 0 to 4 , support LUT
Image Buffer	64MB
Image Format	Mono8/10/10Packed/12/12Packed
Image Sensor	1/2.5"CMOS
Lens Mount	C-mount
Mono/Color	Mono
Pixel	5.0MP
Pixel Size	2.2 x 2.2
Port	GigE
Power Consumption	12V≈2.8W
Power Supply	DC 9V~24V power supply via Hirose interface
Product Dimensions	29mm*29mm*29mm