

A3504CG100E

Product Features

Gigabit Ethernet interface, providing 1Gbps bandwidth with a maximum transmission distance of 100m;
128MB on-board cache for data transmission or image resend;
Support Software Trigger/Hardware Trigger/Free Run Mode;
Support ISP functions including Sharpness/Denoising/Gamma/LUT/BlackLevel Correction/TargetBrightness/Contrast etc.;
Color cameras support interpolation, white balance, color conversion matrix, chroma, saturation, etc.;
Support multiple image data formats output/ROI/Mirror, etc.;



Dimensions (mm)

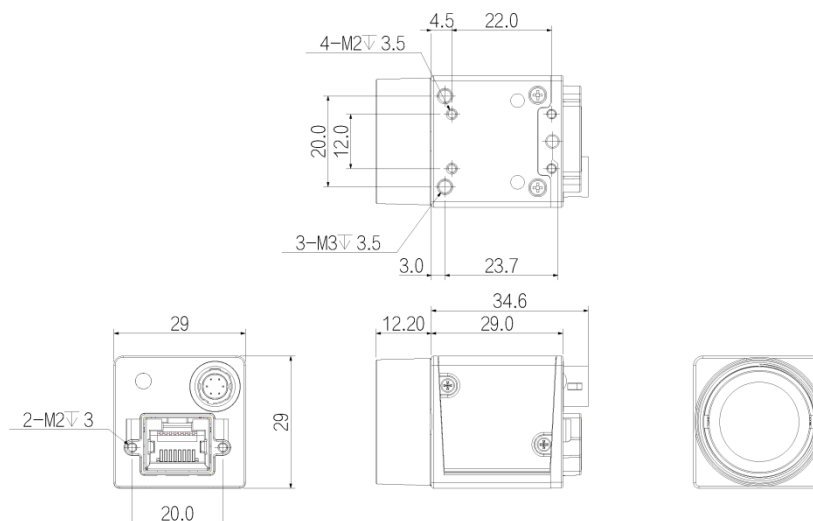

Technical Specifications

| Model Name | A3504CG100E |
|---------------------|---|
| Bit Depth | 12 |
| Frame Rate | 23 |
| GPIO Interface | 1x 6 pin Hirose: 1x Opto-isolated input, 1x Opto-isolated output, 1 configurable input and output |
| Gain | 1~32 |
| Gamma | From 0 to 4 , support LUT |
| Image Buffer | 64MB |
| Image Format | Mono8 , BayerRG8/10/10Packed/12/12Packed , BayerGB8/10/10Packed/12/12Packed , RGB8Packed,YUV422Packed ; |
| Image Sensor | 1/2.5"CMOS |
| Lens Mount | C-mount |
| Mono/Color | Color |
| Pixel | 5.0MP |
| Pixel Size | 2.2 x 2.2 |
| Port | GigE |
| Power Consumption | 12V≈2.8W |
| Power Supply | DC 9V~24V power supply via Hirose interface |
| Product Dimensions | 29mm*29mm*29mm |
| ROI | Support |
| Resolution | 2592 x 1944 |
| S/N Ratio | 40dB |
| SPC | Support |
| Sensor | AR0521 |
| Shutter | Rolling |
| Trigger Mode | Software Trigger/Hardware Trigger/Free Run Mode |
| User Setting | Support two sets of user-defined configurations |
| WDR | 74.3dB |
| Weight | 60g |
| White Balance | Support |
| Working Environment | Storage: - 30°C~ 80°C ; Operation: - 30°C~ 50°C |