

A3124CG100E

Product Features

Gigabit Ethernet interface, providing 1Gbps bandwidth with a maximum transmission distance of 100m;
128MB on-board cache for data transmission or image resend;
Support Software Trigger/Hardware Trigger/Free Run Mode;
Support ISP functions including Sharpness/Denoising/Gamma/LUT/BlackLevel Correction/TargetBrightness/Contrast etc.;
Color cameras support interpolation, white balance, color conversion matrix, chroma, saturation, etc.;
Support multiple image data formats output/ROI/Mirror, etc.;



Dimensions (mm)

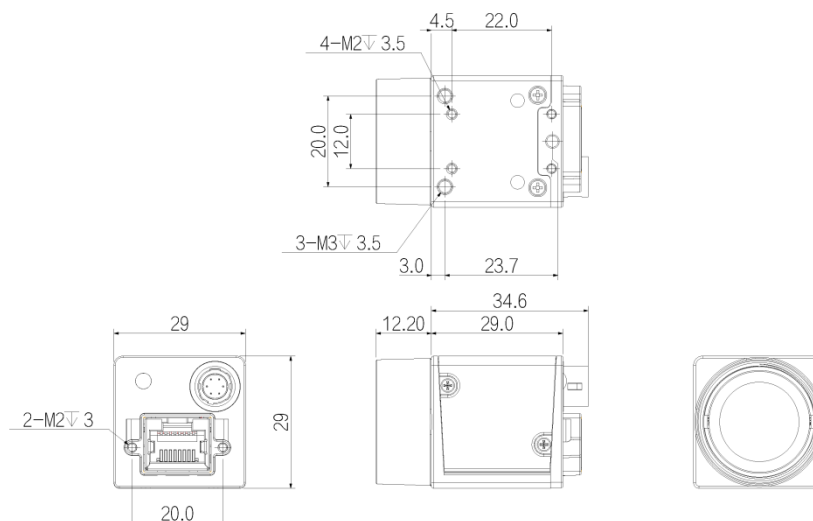

Technical Specifications

Model Name	A3124CG100E
Bit Depth	12
Exposure Time	18.7μS~1S
Frame Rate	54
GPIO Interface	1x 6 pin Hirose: 1x Opto-isolated input, 1x Opto-isolated output, 1 configurable input and output
Gain	1~32
Gamma	From 0 to 4 , support LUT
Image Buffer	64MB
Image Format	Mono8 , BayerRG8/10/10Packed/12/12Packed , BayerGB8/10/10Packed/12/12Packed , RGB8Packed,YUV422Packed
Image Sensor	1/3"CMOS
Lens Mount	C-mount
Mono/Color	Color
Pixel	1.2MP
Pixel Size	3.75 x 3.75
Port	GigE
Power Consumption	12V≈2.8W
Power Supply	DC 9V~24V power supply via Hirose interface
Product Dimensions	29mm*29mm*29mm
ROI	Support
Resolution	1280 x 960
S/N Ratio	40.7dB
SPC	Support
Sensor	AR0135
Shutter	Global
Trigger Mode	Software Trigger/Hardware Trigger/Free Run Mode
User Setting	Support two sets of user-defined configurations
WDR	71.1dB
Weight	60g
White Balance	Support
Working Environment	Storage: - 30°C~ 80°C ; Operation: - 30°C~ 50°C